



617 Van Sinderen Ave. Brooklyn, NY 11207  
T +1 347 889 7570  
info@mfdnyc.com

## VEGA SCNCE / CEILING MOUNT

---



### DESCRIPTION

---

Add some sparkle to your spaces with our gem-like Vega Collection. Warm metals in a number of finishes mix with glittery hand-carved onyx or cast glass. We understand your need for versatile design solutions. More beautiful than Vega's sparkle, is the ability to create custom configurations with ease. Surface mounted as a stand-alone gem, paired in twos, even joined together endlessly, or hanging as a chandelier in linear or geometric arrangements—lighting truly becomes the jewelry of the home with Vega.

### YEAR OF DESIGN

2016

### MATERIAL

Anodized aluminum body, with brass accents and onyx or cast glass diffusers.



617 Van Sinderen Ave. Brooklyn, NY 11207  
T +1 347 889 7570  
info@mfdnyc.com

## VEGA SCONCE / CEILING MOUNT

---

### VEGA SCONCE UNO

7.5"W x 6.5" x 5.5" Body Height  
640 Lumens LED / 2700K

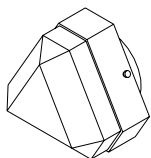

### VEGA SCONCE DUE

13"L x 7.5"W x 5.5" Body Height  
1280 Lumens LED / 2700K

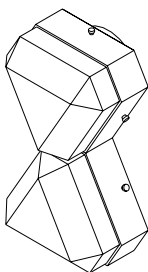

### VEGA CEILING MOUNT UNO

7.5"W x 6.5" x 5.5" Body Height  
640 Lumens LED / 2700K

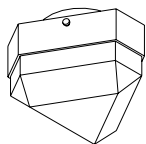

### VEGA CEILING MOUNT DUE

13"L x 7.5"W x 5.5" Body Height  
1280 Lumens LED / 2700K

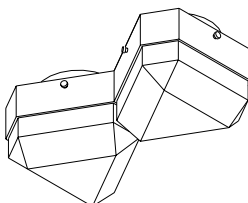

## SPECIFICATIONS

---

- Vega is a modular lighting fixture composed of an anodized body with glass / onyx & brass accents.
- Lamping: Each Vega "pod" contains one dimmable 6 Watt LED / PCB module.
- Lumens: Each LED source radiates 640 lumens at 2700K (Warm White).
- Voltage: Fixture connects directly to AC line voltage. No external driver needed.
- Bulb Life: Average 50,000 Hours. Bulbs are not user serviceable.
- UL certification available in 120V: For additional cost.
- Custom configurations are available.
- Compatible with current (ELV) reverse phase dimmers.

## AVAILABLE FINISHES

---

- Body (Anodized Finishes): Silver, Bronze, Rosegold, Brass, Graphite, Black.
- Body (Plated Finishes): Antique Brass (AB), Polished Nickel (PN): + additional cost.
- Accent Metal (Patinated Finishes): Satin Brass (SB), Antique Brass (AB), Blackened Brass (BB).
- Accent Metal (Plated Finishes): Satin Copper (SC), Satin Nickel (SN), Polished Nickel (PN).
- Diffuser Finishes: Onyx, Clear Glass.