



617 Van Sinderen Ave. Brooklyn, NY 11207
T +1 347 889 7570
info@mfdnyc.com

ROSWELL MIRROR



DESCRIPTION

The Roswell Mirror is inspired by the geometric shapes and patterns of the 1970's. Roswell's sculpted circular frame breaks out of the box, bringing movement and light to your interior spaces. Suspended by four hand-patinated clips, our elongated starphire mirror will capture your attention as you enter a room.

YEAR OF DESIGN

2017

MATERIAL

Ash, Oak, or Walnut frame, with an elongated mirror, and machined metal clips.



617 Van Sinderen Ave. Brooklyn, NY 11207
T +1 347 889 7570
info@mfdnyc.com

ROSWELL MIRROR SERIES

ROSWELL MIRROR (32)

32"L x 32"W x 1.5"D

Patinated Finishes: Included in pricing

Plated Finishes: + Additional cost

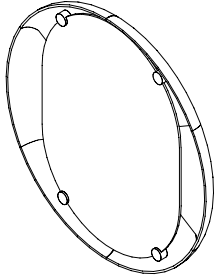

ROSWELL MIRROR (40)

40"L x 40"W x 1.5"D

Patinated Finishes: Included in pricing

Plated Finishes: + Additional cost

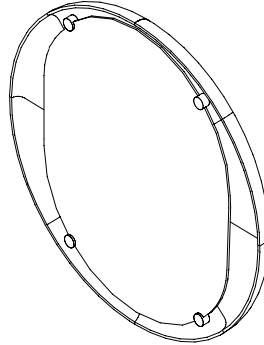

ROSWELL MIRROR (RECTANGLE)

24"W x 36"H x 1.5"D

Patinated Finishes: Included in pricing

Plated Finishes: + Additional cost

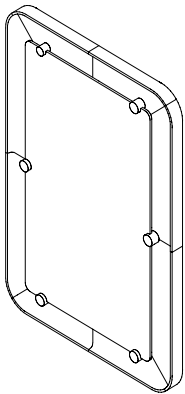

SPECIFICATIONS

- Roswell features a sculpted Ash, Oak, or Walnut frame which encapsulates a mirror with metal accents.
- Hangs vertically or horizontally.
- Includes z-clip for wall mounting.
- Custom configurations are available.

AVAILABLE FINISHES

- Wood Options: Ash, Oak, or Walnut w/ standard MFD satin finishes.
- Patinated Finishes: Satin Brass (SB), Antique Brass (AB), Blackened Brass (BB).
- Plated Finishes: Satin Copper (SC), Satin Nickel (SN), Polished Nickel (PN).